

5 Port Solenoid Valve

Body Ported

Series 4V100

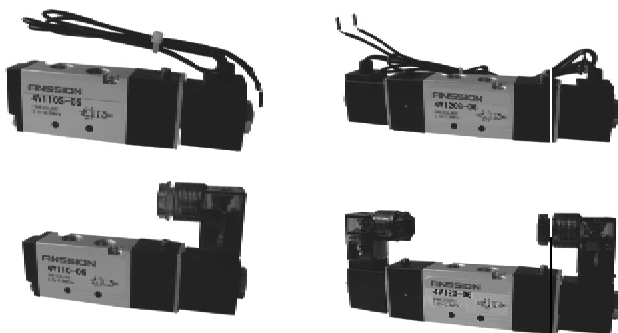

Symbol

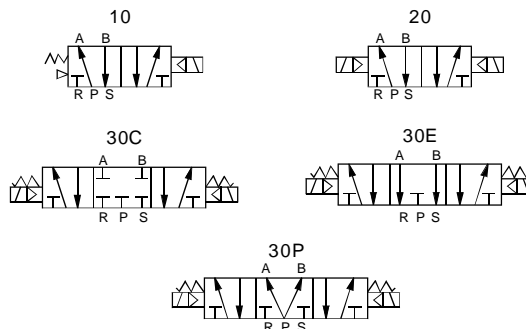

◆ Specifications

Item / Type	4V110-M5	4V120-M5	4V130C-M5	4V130E-M5	4V130P-M5	4V110-06	4V120-06	4V130C-06	4V130E-06	4V130P-06
Fluid	Air									
Action	Internally piloted									
Type of actuation	5 port 2 position		5 port 3 position			5 port 2 position		5 port 3 position		
Orifice size	5.5mm ² (Cv=0.31)		5mm ² (Cv=0.28)			12mm ² (Cv=0.67)		9mm ² (Cv=0.50)		
Port size	In=Out=Exhaust=M5					In=Out=Exhaust=1/8				
Lubrication	Not required									
Operating pressure range	0.15~0.8 MPa									
Proof pressure	1.2 MPa									
Ambient and fluid temperature	-5~60℃(No freezing)									
Allowable voltage fluctuation	±10% of rated voltage									
Power consumption	AC: 3.0VA DC: 2.5W									
Insulation	F class									
Protection	IP65(DIN40050)									
Electrical entry	DIN terminal / Grommet									
Max.operating frequency	5 Hz		3 Hz			5 Hz		3 Hz		
Min.activating time	0.05sec									
Weight	120g	175g	200g	200g	200g	120g	175g	200g	200g	200g

◆ How to Order

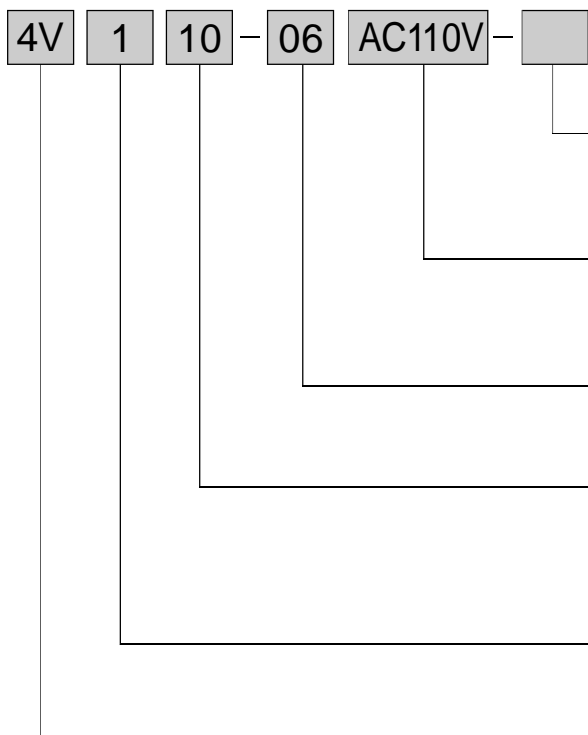

Electrical entry

Nil	DIN terminal with connector
G	Grommet(Lead wire:450mm)

Rated voltage

DC12V		DC24V		AC24V	50/60Hz
AC110V	50/60Hz	AC220V	50/60Hz	AC380V	50/60Hz

Port size

M5	M5×0.8	06	1/8
----	--------	----	-----

Type of actuation

10	Single solenoid	20	Double solenoid
30C	Closed center	30E	Exhaust center
30P	Pressure center		

Series

1	100 Series
---	------------

Model

4V	5 port 2(3) position solenoid valve
----	-------------------------------------

II

VF

SY

SYJ

4V100

4V200

4V300

4V400

VT307

VP

3V

2W

2WH

2L

2V

2P

VFA

SYA

4A100

4A200

4A300

3A100

3A200

3A300

3L

4L

4H

SL,SH

4HV

HV,K

3FM

3F

4F

FV

MSV

MOV

JM

TAC

HSV

RE

ASC

KA

ACV

KS

QE

Manifold

5 Port Solenoid Valve
Body Ported
Series 4V100

◆ **Dimensions**

4V110-M5

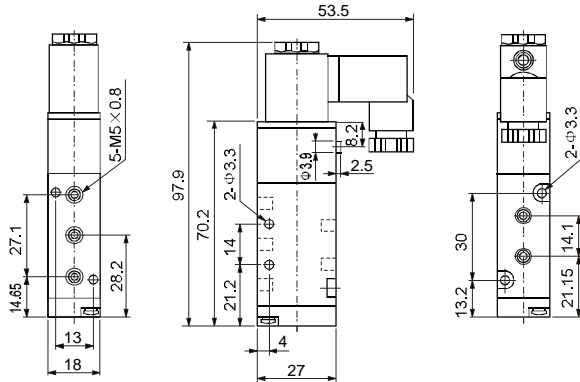

4V110-06

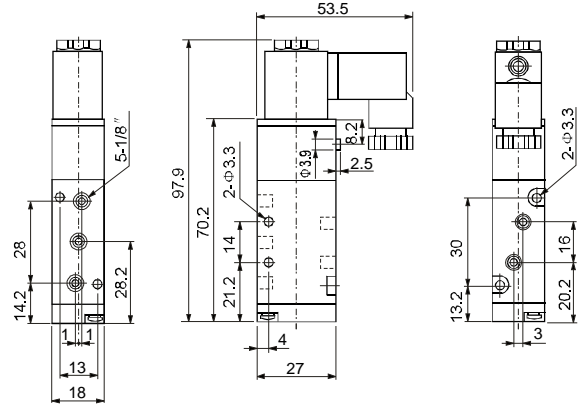

4V120-M5

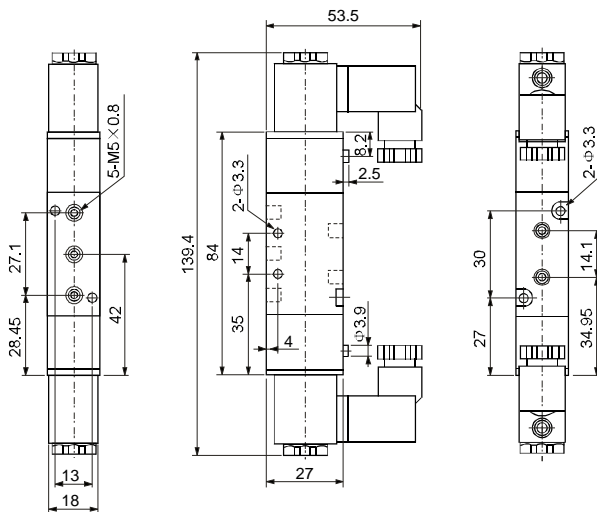

4V120-06

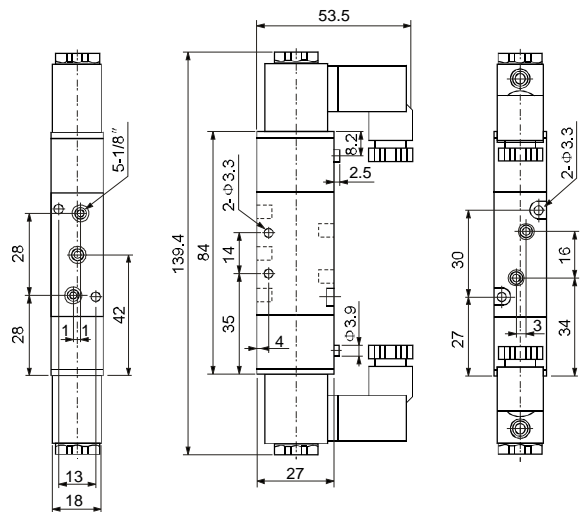

4V130-M5

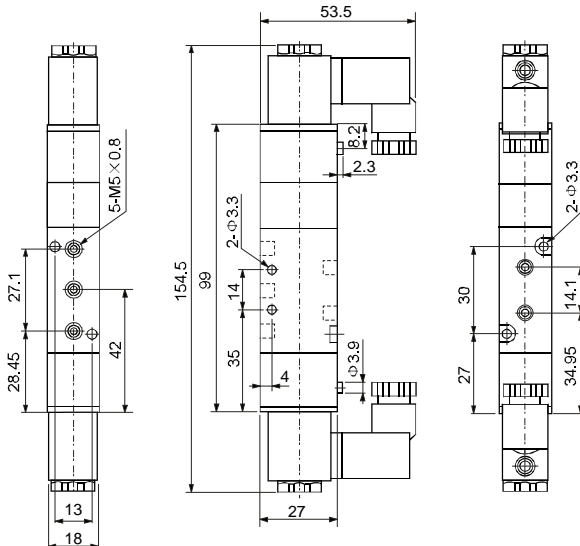

4V130-06

